



Renkus Heinz STX 4 Loudspeakers shown



JBL AE Series Loudspeakers shown



GridLink™ Pivoting Beam Connector

GridLink™

Overhead Suspension System

The GridLink™ Rigging Beam System provides the foundation for building quick and reliable loudspeaker suspension grids using predictable load-rated, modular and off-the-shelf components. Cabinets are suspended then aimed precisely and without affecting the angles of the other cabinets.

GridLink™ suspension grids are comprised of standard length beams and beam connectors. The GridLink™ connectors act as a heavy-duty beam coupler and load-rated suspension point. In addition, they pivot horizontally to create a wide variety of grid sizes and shapes including rectangles, squares, hexagons and triangles.

Once assembled the GridLink™ provides a solid suspension system for full arrays and clusters in single and multiple tiers offering

unprecedented precision and ease in the aiming of loudspeakers. Up to 360° of horizontal adjustment is attainable using the Gridlink™ Cross Arm Kit and 90° of vertical adjustment is achievable through the use of ALLEN U-Series mounts and the Steerable™ Tilt Cable Kit system

GridLink™ suspension grids make permanent and live sound installations fast and efficient and lend themselves ideally to theaters, churches, school, auditoriums, fitness centers, gymnasiums and theme parks.

GridLink™ Rigging Beam components are produced from rugged structural steel shapes and come with domestically produced and load rated suspension hardware to assure strong and reliable installations.

WORKING LOAD LIMITS (5:1 TO YIELD POINT):

Model #:	Description:	WLL: lbs/ kg
SAS-024-RB	23.75" Gridlink™ beam	650/295
SAS-036-RB	35.75" Gridlink™ beam	600/272
SAS-048-RB	47.75" Gridlink™ beam	550/250
SAS-066-RB	65.75" Gridlink™ beam	500/227
SAS-086-RB	86.00" Gridlink™ beam	450/204

OPTIONAL COMPONENTS:

Model #:	Description:	WLL: lbs/kg
1. SAS-GL	SAS-GL GridLink™ Connector kit	2200/1000
2. SAS-GLT	SAS-GLT GridLink™ T-Connector kit	2200/1000
3. SAS-100-CA	SAS-100-CA GridLink™ Cross Arm kit	300/136
4. SAS-EB-KT	SAS-EB-KT Eyebolt suspension kit	2200/1000
5. TCK-XXX	Steerables™ Tilt Cable kit	220/100
6. GT-024	GridLink Tensioner Kit	Does not apply
7. SAS-GL-BK	Rigging Beam Bolt Kit	2200/1000

STANDARD FEATURES:

- Modular approach to arrays and clusters
- Quick set up and aiming
- Off the shelf, ready-to-ship to the job site
- Ultra-precise loudspeaker aiming
- Multiple tier capable
- Predictable, load rated components

SPECIFICATIONS:

- Material: Structural steel alloy
- Finish: Powder coat
- Colors: Flat black & off-white

A division of:
ADAPTIVE TECHNOLOGIES GROUP
 1635 E. Burnett Street
 Signal Hill, CA 90755 USA
 PH: 562.424.1100 FX: 562.424.3520



www.atmflyware.com

GridLink™

Rigging Beam Systems

DIMENSIONS:

SAS-024-RB:

24" Rigging Beam

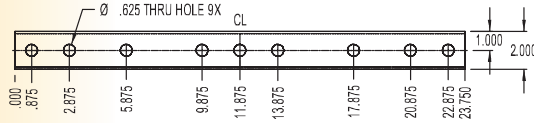

SAS-036-RB:

36" Rigging Beam

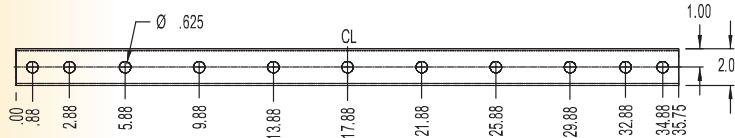

SAS-048-RB:

48" Rigging Beam

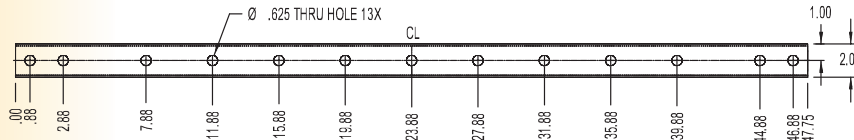

SAS-066-RB:

66" Rigging Beam

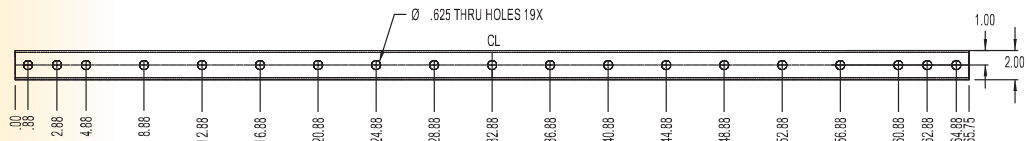

SAS-086-RB:

86" Rigging Beam

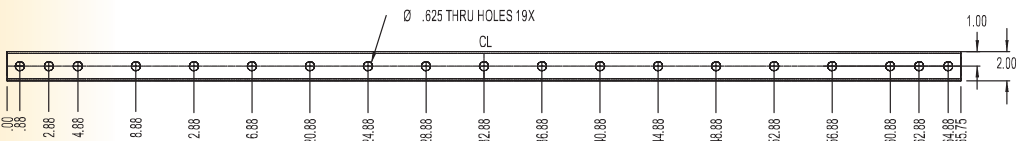

TYPICAL GRIDLINK™ CONFIGURATIONS:

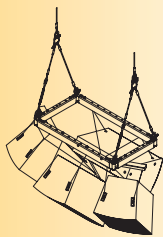

Up to 180° coverage with back fill

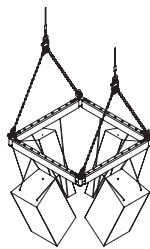

Up to 360° coverage

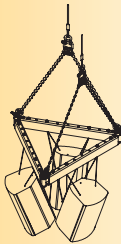

Triangular configuration: 360° coverage

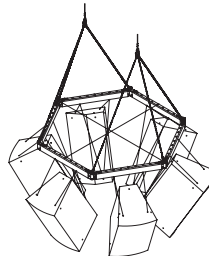

Hexagonal configuration: 360° coverage
(Using GT-024 Tension Cable Kit)

COMPONENTS OPTIONS:

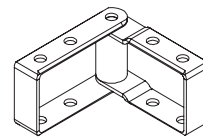

SAS-GL: Beam Connector

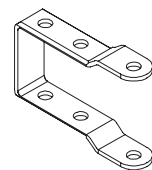

SAS-GLT: "T" Connector

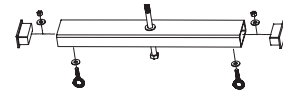

SAS-100-CA: Cross Arm Kit



SAS-EB-KT: Eyebolt Suspension Kit



GT-024 Tension Cable Kit

A division of:
ADAPTIVE TECHNOLOGIES GROUP

1635 E. Burnett Street
Signal Hill, CA 90755 USA
PH: 562.424.1100 FX: 562.424.3520



www.atmflyware.com